

TECHNICAL DATA SHEET

NOZZLE SECTION • NS

Used to suppress fire or to connect to a cleaning system. To be connected to a drain of 1"Ø (25mm) – NPT.

Includes:

- 1 Assembly band (AB)
- 1 Finishing band (FB)

K = Same as pipe length

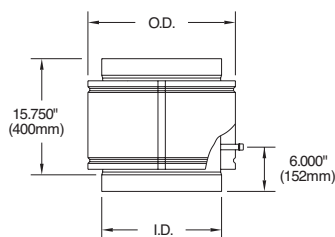

AVAILABLE FOR MODELS:

GDP/GDPL/GDPL2F/GDPL4F